

//halo merchandising unit

cutting edge design
versatility
attention to detail

//halo merchandising unit

retail display solution

//halo merchandising unit

unibox[®]
retail display

Constructed from Unibox Modular Aluminium Profiles and Class One fire-rated, beech laminated MDF panels. Alternative finishes available on request.

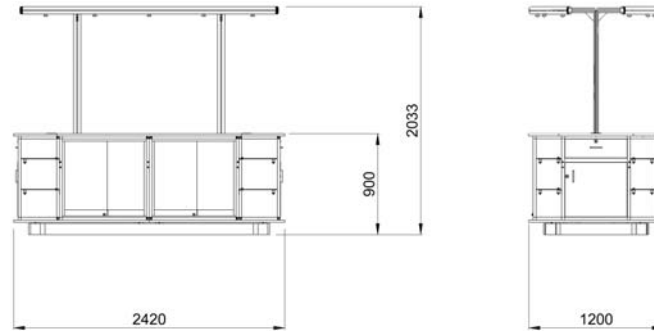

//halo merchandising unit

Cutting edge design, high quality, attention to detail, versatility, efficiency in production, all are synonymous with the Halo unit and all Unibox products.

The Halo RMU offers the perfect quality, retail display solution to independent and multiple traders alike. You can specify The Halo unit to suit your individual display requirements.

Features & benefits:

- Halo lighting canopy featuring 10 spot lights
- Secure storage
- Lockable castors for ease of movement
- Fire rated, durable materials
- Cable management for till point
- Extensive range of accessories
- Fully extendable draw to front

If you require an alternative layout or design, other than the halo, please visit our gallery at www.unibox.co.uk/rmu, for inspiration. Alternatively you may wish to contact us directly on 0161 277 6020.



cutting edge design

versatility

attention to detail

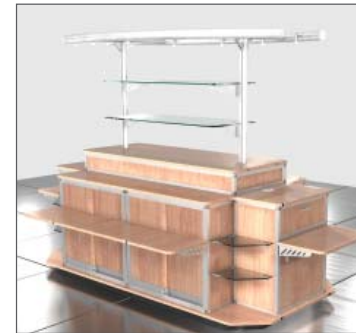

Octagon Shopping Centre –
Burton on Trent

For more information or to arrange for our RMU specialist to visit, please contact us today on 0161 277 6020 // email sales@unibox.co.uk

www.unibox.co.uk/rmu

www.unibox.co.uk/rmu

//accessories 1

Start with a base unit, illustrated on the left, then build up by adding any or all of the following:

- //1. Central, eye level, glass display shelves
- //2. Central staging
- //3. Side cantilever shelving
- //4. End cantilever shelving
- //5. Signage

Adding all of the above to the generic base unit results in an RMU as illustrated.

For further accessory options see the back page of this leaflet.

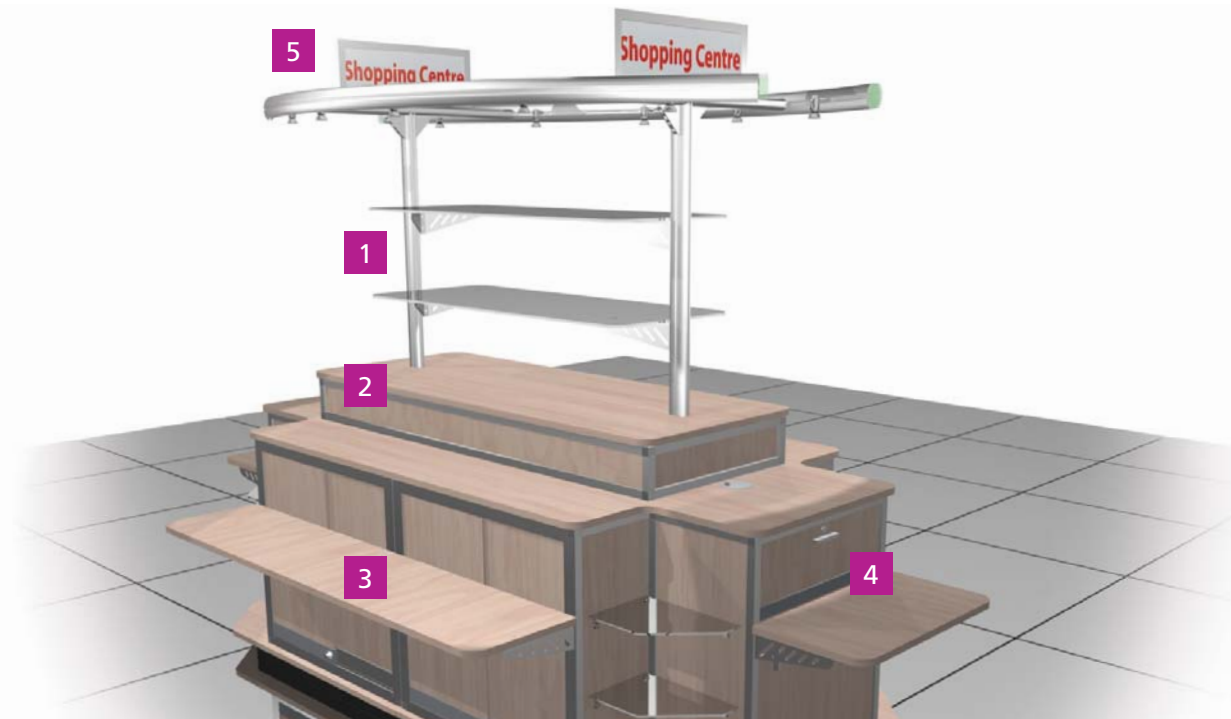

1 HL001
Central Glass Shelves
8mm toughened glass, with polished edges
Size: 1200mm x 500mm



2 HL002
Central staging unit
20mm Laminated MDF to suit base unit
Size: 1650mm x 660mm x 200mm



3 HL003
Cantilever timber side shelf
20mm laminated MDF to suit base unit
Size: 1620mm x 350mm



4 HL004
Cantilever timber end shelf
20mm laminated MDF to suit base unit
Size: 630mm x 350mm



5 HL005
Signage to light canopy

//halo merchandising unit

//accessories 2

For more information or to arrange for our RMU specialist to visit, please contact us today:

// t: 0161 277 6020
 // e: sales@unibox.co.uk
 // www.unibox.co.uk/rmu

For added versatility, a secure showcase or aluminium slatwall panel, can be retrofitted to the basic Halo unit. This provides maximum flexibility to suit individual traders display requirements. Lockable castors are also fitted as standard, thereby creating a fully mobile display.



HL006
Slatwall Panel
 Double sided aluminium slatwall panel

Size: 1220mm x 1080mm



UA 4468
Acrylic Slatwall Shelf
 Size: 300mm x 150mm



HL007
Steel Slatwall Hook
 Size: 350mm



HL008
Secure Glass Showcase
 2 adjustable glass shelves

Size: 1200mm x 400 x 1000mm



Fully secure unit.
 Push-in lock for added security



Adjustable glass shelf

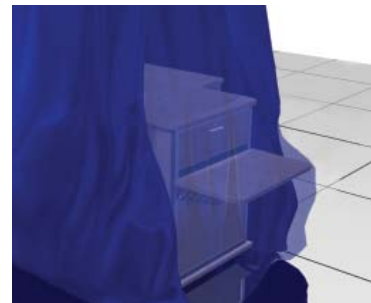

HL009
Night Sheet – Royal Blue
 Nylon cover sheet to suit. Supplied as standard with every unit.

Alternative colours and additional sheets available on request.



Also available in black



Also available in grey

//halo merchandising unit

slatwall option

glass showcase

night cover